



**CAPACITY CHART**

NOZZLE NUMBER	DIA. (mm)	FLOW RATE IN LITRES/MIN AT Bar.G.			
		1	2	3	4
1505-8	0,20	,018	,026	,032	,036
1505-10	0,25	,030	,042	,051	,059
1505-12	0,30	,041	,058	,071	,082
1505-14	0,36	,057	,081	,099	,114
1505-15	0,38	,064	,090	,111	,128
1505-16	0,41	,073	,103	,126	,146
1505-17	0,43	,082	,116	,142	,164
1505-18	0,46	,091	,129	,158	,182
1505-19	0,48	,103	,145	,178	,205
1505-20	0,51	,112	,158	,193	,223
1505-22	0,56	,135	,190	,233	,269
1505-24	0,61	,169	,239	,292	,337
1505-25	0,64	,182	,258	,316	,365
1505-26	0,66	,198	,280	,344	,397
1505-28	0,71	,228	,322	,395	,456
1505-29	0,74	,246	,348	,426	,492
1505-30	0,76	,262	,371	,454	,524
1505-32	0,81	,285	,403	,494	,570
1505-34	0,86	,312	,442	,541	,625
1505-35	0,89	,328	,464	,569	,657
1505-37	0,94	,367	,519	,636	,734
1505-39	0,99	,413	,584	,715	,825

**TYPE 1505**

**SPRAY CHARACTERISTICS**

- Calibrated metering orifice for regulating liquid fluids.
- Straight stream jet with needle type spray.

**CONSTRUCTION AND MATERIALS**

- Burr-free orifice to provide consistent flow with minimum deviation.
- Available in 302 Stainless Steel only.
- Used with Standard bodies and caps.

**ORDER EXAMPLE**

1505-45.

NOZZLE NUMBER	DIA. (mm)	FLOW RATE IN LITRES/MIN AT Bar.G.				NOZZLE NUMBER	DIA. (mm)	FLOW RATE IN LITRES/MIN AT Bar.G.			
		1	2	3	4			1	2	3	4
1505-41	1,04	,499	,635	,778	,898	1505-78	1,98	1,76	2,48	3,04	3,51
1505-43	1,09	,492	,696	,853	,985	1505-80	2,03	1,85	2,61	3,20	3,69
1505-45	1,14	,540	,764	,936	1,08	1505-81	2,05	1,89	2,68	3,28	3,78
1505-46	1,17	,565	,800	,979	1,13	1505-83	2,11	1,98	2,81	3,44	3,97
1505-47	1,19	,593	,838	1,03	1,19	1505-86	2,18	2,05	2,90	3,55	4,1
1505-48	1,22	,616	,870	1,07	1,23	1505-89	2,26	2,2	3,11	3,31	4,4
1505-49	1,24	,638	,903	1,11	1,28	1505-91	2,31	2,23	3,16	3,87	4,47
1505-51	1,30	,684	,967	1,18	1,37	1505-93	2,36	2,3	3,26	3,99	4,61
1505-52	1,32	,72	1,02	1,25	1,44	1505-95	2,41	2,51	3,55	4,34	5,02
1505-54	1,37	,775	1,1	1,34	1,55	1505-98	2,49	2,67	3,77	4,62	5,34
1505-55	1,40	,807	1,14	1,4	1,61	1505-105	2,62	2,96	4,19	5,13	5,93
1505-57	1,45	,866	1,23	1,5	1,73	1505-107	2,72	3,19	4,51	5,53	6,38
1505-59	1,50	,926	1,31	1,6	1,85	1505-110	2,79	3,42	4,84	5,92	6,84
1505-61	1,55	1,0	1,42	1,74	2,01	1505-115	2,92	3,88	5,48	6,71	7,75
1505-63	1,60	1,09	1,55	1,90	2,19	1505-120	3,05	4,01	5,67	6,95	8,03
1505-65	1,65	1,16	1,64	2,01	2,33	1505-125	3,18	4,74	6,71	8,21	9,48
1505-67	1,70	1,25	1,77	2,17	2,51	1505-140	3,56	5,75	8,13	9,95	11,5
1505-68	1,73	1,28	1,81	2,21	2,55	1505-156	3,96	7,25	10,3	12,6	14,5
1505-70	1,78	,140	1,98	2,42	2,80	1505-177	4,50	9,23	13,1	16,0	18,5
1505-72	1,83	1,46	2,06	2,53	2,92	1505-196	4,98	11,2	15,9	19,5	22,5
1505-73	1,85	1,54	2,18	2,67	3,08	1505-218	5,54	14,2	20,1	24,6	28,5
1505-75	1,91	1,60	2,26	2,76	3,19	1505-234	5,94	16,2	23,0	28,1	32,5



**TYPE RO**

**SPRAY CHARACTERISTICS**

- Calibrated metering orifice for regulating liquid fluids.
- Straight stream jet with needle type spray.

**CONSTRUCTION AND MATERIALS**

- One piece construction with Male BSPT thread.
- Burr-free orifice to provide consistent flow with minimum deviation.
- Brass and Stainless Steel are standard.
- Other materials are available to special order.

**ORDER EXAMPLE**

Specify thread size required, together with orifice size and orifice length as follows:

3/8" RO x 3.0mm x 10.0mm.

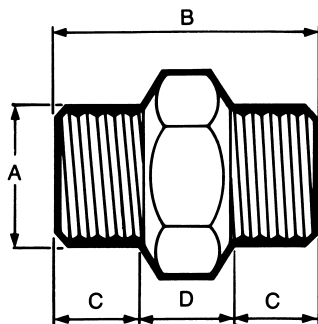

**DIMENSIONS AND WEIGHTS**

BSPT Thread Size	Dimensions (mm)			Weight (g)
	A	B	C	
1/4"	25,4	9,5	6,4	28
3/8"	33,3	12,7	7,9	57
1/2"	38,1	12,7	12,7	99
3/4"	44,5	14,3	15,9	170
1"	57,2	20,6	15,9	184

Contact our Helpline for any special requirements:  
Tel: +44 (0) 151 424 6821  
Fax: +44 (0) 151 495 1043  
e-mail:sales@delavan.co.uk  
Web:www.delavan.co.uk